

Summary



Community	Estimated Pavement & Markings Improvements Per Fiscal Year				
	2024-25	2026-27	2028-29	2032-33	2034-35
St. Moritz			\$186,134		
The Towns at St. Moritz				\$55,194	
Monaco					\$100,685
Santorini			\$151,332		
Madeira		\$111,605			
Netherlands		\$39,686			
Promenade Shores		\$123,102			
Antilles (Completed in 2025)	\$259,776				
Total Recommended Budget Per Fiscal Year	\$259,776	\$274,393	\$337,466	\$55,194	\$100,685
St. Moritz Estates, Menorca & Corsica	City Responsible for Pavement Renewal in These Communities				



## Towns at St. Moritz



### St Moritz Southwest Recommendations

1. Year Asphalt Built: 2012
2. End of Service Life: 2032
3. Service Life Remaining: 8 Years
4. Pavement Condition: Good
5. Pavement Marking Condition: Good
6. Recommendation:  
Mill, Resurface and Repaint in FY 2032-33  
Estimated project cost shown below.

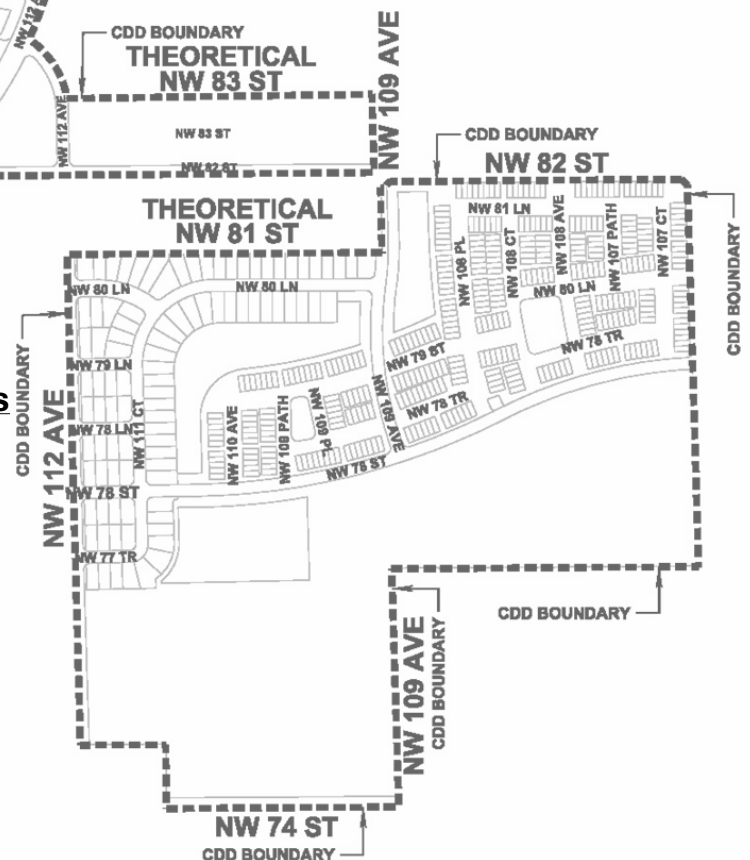

Estimated Costs Asphalt (Table Above) and Markings (Table Below)									
Pavement Service Life (20 Years Estimated)		Present Year	Remaining Service Life (Yrs)	Present Year Cost (PC) of Pavement Replacement (Mill and Resurface 3/4" Thick)			Future Replacement Cost @ End of Service Life*	Annual Interest Rate	Annuity to Finance (FC) in (n) Years given (i)
From	To		(n)	Quantity (SY)	Unit Cost (\$/SY)	(PC)	(FC)	(i)	$FCi/((1+i)^n-1)$
2012	2032	2024	8	3,582	\$10.00	\$35,822	\$45,995	0.25%	\$5,699

From	To		(n)	Quantity (SY)	Unit Cost (\$/SY)	(PC)	(FC)	(i)	$FCi/((1+i)^n-1)$
2012	2032	2024	8	3,582	\$2.00	\$7,164	\$9,199	0.25%	\$1,140



Monaco

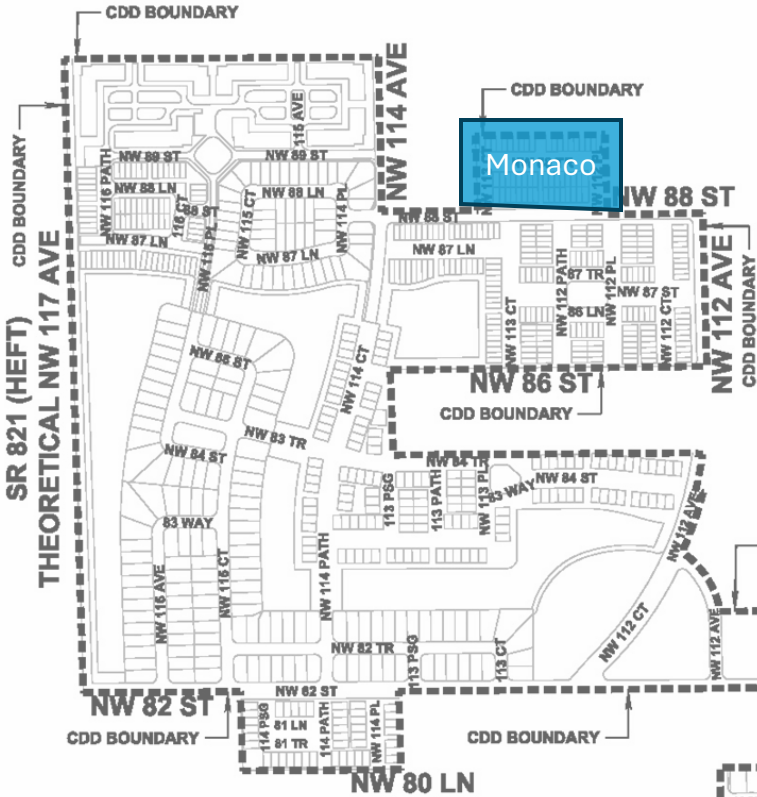

Villa Bello Recommendations

- 1. Year Asphalt Built: 2014
- 2. End of Service Life: 2034
- 3. Service Life Remaining: 10 Years
- 4. Pavement Condition: Good
- 5. Pavement Marking Condition: Good
- 6. Recommendation:  
Mill, Resurface and Repaint in FY 2034-35  
Estimated project cost shown below.

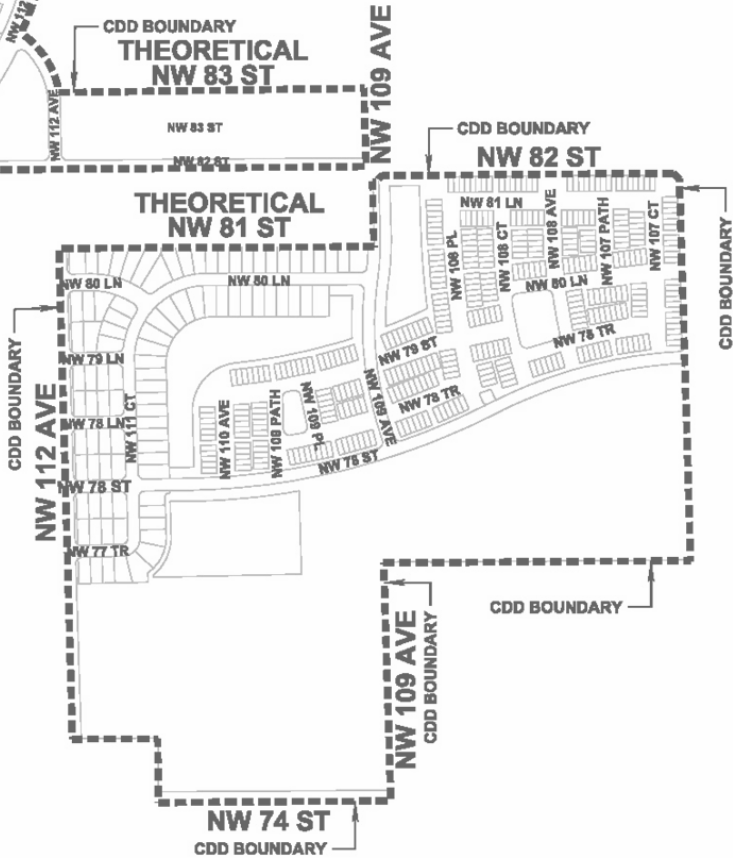

Estimated Costs Asphalt (Table Above) and Markings (Table Below)									
Pavement Service Life (20 Years Estimated)		Present Year	Remaining Service Life (Yrs)	Present Year Cost (PC) of Pavement Replacement (Mill and Resurface 3/4" Thick)			Future Replacement Cost @ End of Service Life*	Annual Interest Rate	Annuity to Finance (FC) in (n) Years given (i)
From	To		(n)	Quantity (SY)	Unit Cost (\$/SY)	(PC)	(FC)	(i)	$FCi/((1+i)^n-1)$
2014	2034	2024	10	6,124	\$10.00	\$61,244	\$83,904	0.25%	\$8,296

From	To		(n)	Quantity (SY)	Unit Cost (\$/SY)	(PC)	(FC)	(i)	$FCi/((1+i)^n-1)$
2014	2034	2024	10	6,124	\$2.00	\$12,249	\$16,781	0.25%	\$1,659



1. Year Asphalt Built: 2008
2. End of Service Life: 2028
3. Service Life Remaining: 4 Years
4. Pavement Condition: Fair
5. Pavement Marking Condition: Fair
6. Recommendation:  
Mill, Resurface and Repaint in FY 2028-29  
Estimated project cost shown below.

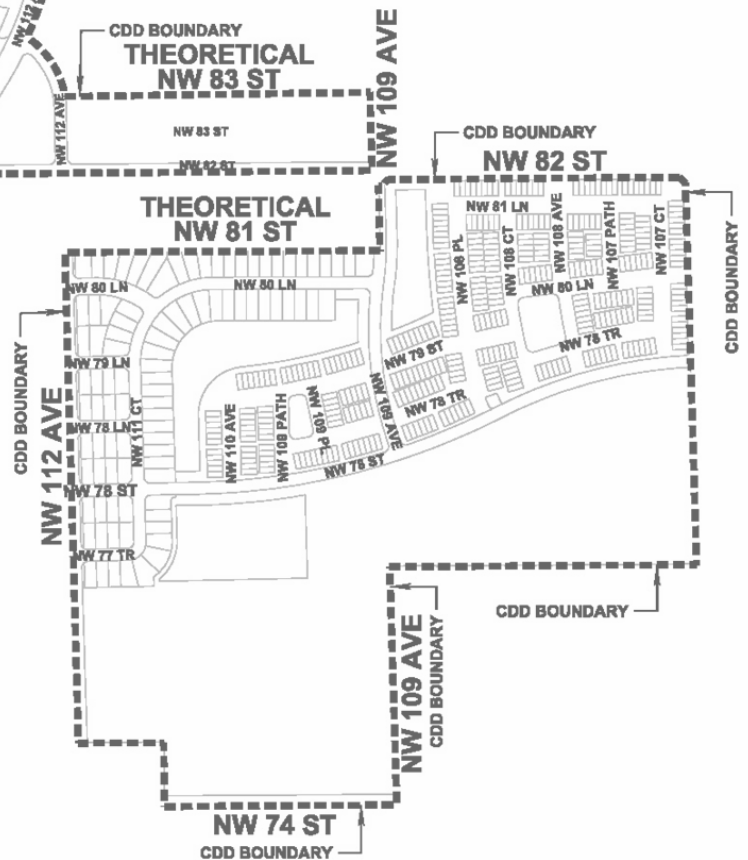

Estimated Costs Asphalt (Table Above) and Markings (Table Below)									
Pavement Service Life (20 Years Estimated)		Present Year	Remaining Service Life (Yrs)	Present Year Cost (PC) of Pavement Replacement (Mill and Resurface 3/4" Thick)			Future Replacement Cost @ End of Service Life*	Annual Interest Rate	Annuity to Finance (FC) in (n) Years given (i)
From	To				(n)	Quantity (SY)			
2008	2028	2024	4	11,180	\$10.00	\$111,800	\$126,110	0.25%	\$31,410

From	To		(n)	Quantity (SY)	Unit Cost (\$/SY)	(PC)	(FC)	(i)	$FCi/((1+i)^{n-1})$
2008	2028	2024	4	11,180	\$2.00	\$22,360	\$25,222	0.25%	\$6,282

## Madeira

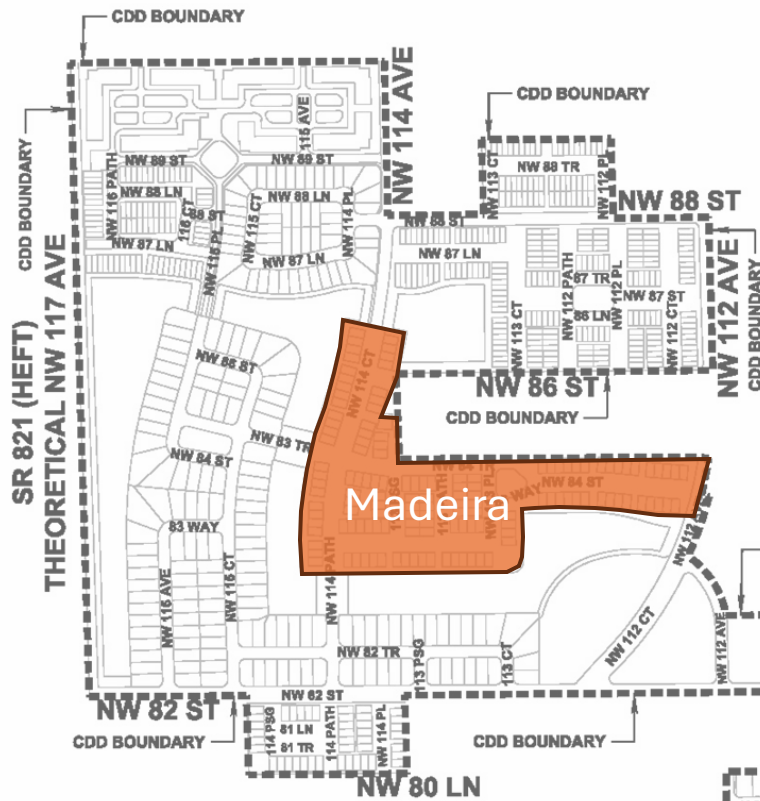

### Madeira Recommendations

1. Year Asphalt Built: 2006
2. End of Service Life: 2026
3. Service Life Remaining: 2 Years
4. Pavement Condition: Fair
5. Pavement Marking Condition: Fair
6. Recommendation:  
Mill, Resurface and Repaint in FY 2026-27  
Estimated project cost shown below.

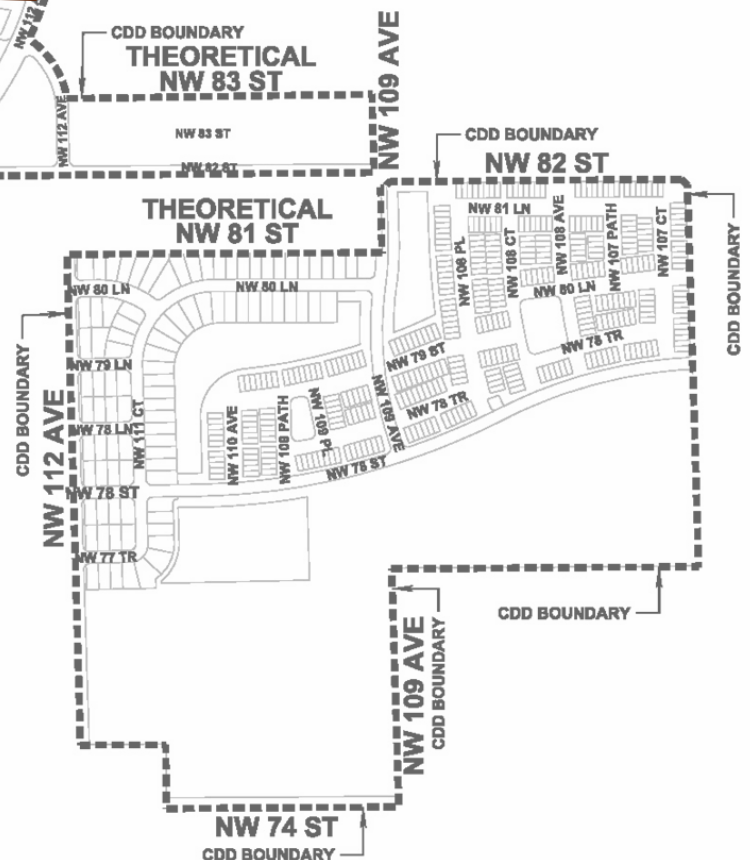

Estimated Costs Asphalt (Table Above) and Markings (Table Below)

Pavement Service Life (20 Years Estimated)		Present Year	Remaining Service Life (Yrs)	Present Year Cost (PC) of Pavement Replacement (Mill and Resurface 3/4" Thick)			Future Replacement Cost @ End of Service Life*	Annual Interest Rate	Annuity to Finance (FC) in (n) Years given (i)
From	To		(n)	Quantity (SY)	Unit Cost (\$/SY)	(PC)	(FC)	(i)	$FCi/((1+i)^n-1)$
2006	2026	2024	2	8,774	\$10.00	\$87,740	\$93,004	0.25%	\$46,444

From	To		(n)	Quantity (SY)	Unit Cost (\$/SY)	(PC)	(FC)	(i)	$FCi/((1+i)^n-1)$
2006	2026	2024	2	8,774	\$2.00	\$17,548	\$18,601	0.25%	\$9,289



# Netherlands

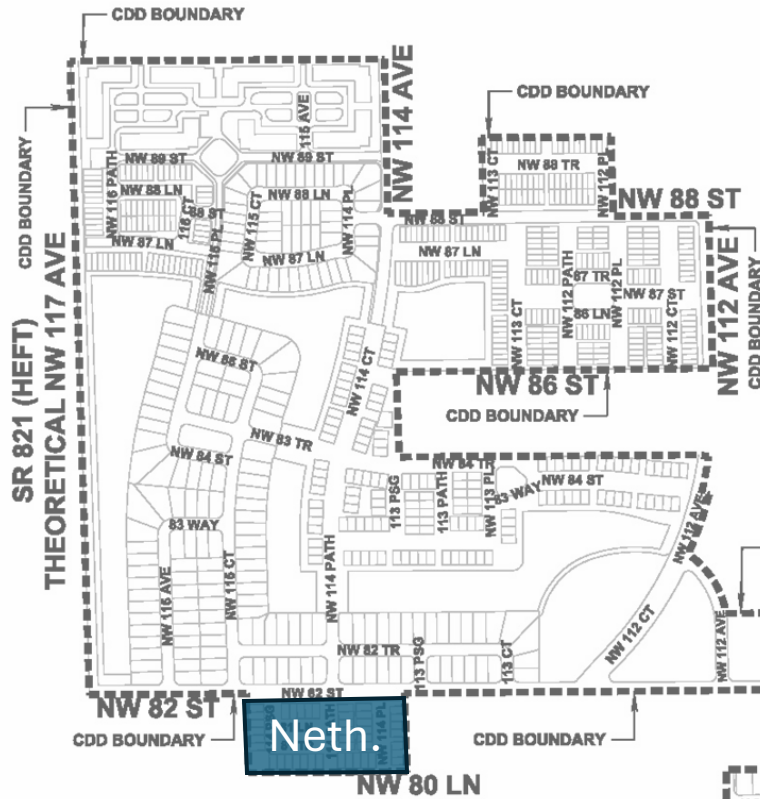

## Neherlands Recommendations

1. Year Asphalt Built: 2006
2. End of Service Life: 2026
3. Service Life Remaining: 2 Years
4. Pavement Condition: Fair
5. Pavement Marking Condition: Good
6. Recommendation:  
Mill, Resurface and Repaint in FY 2026-27  
Estimated project cost shown below.

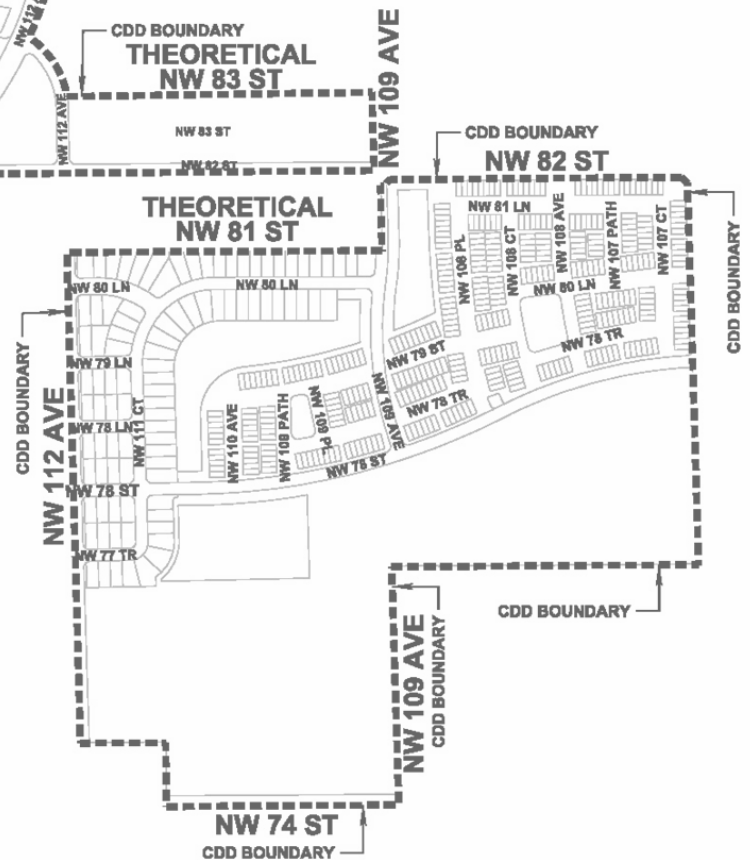

Estimated Costs Asphalt (Table Above) and Markings (Table Below)									
Pavement Service Life (20 Years Estimated)		Present Year	Remaining Service Life (Yrs)	Present Year Cost (PC) of Pavement Replacement (Mill and Resurface 3/4" Thick)			Future Replacement Cost @ End of Service Life*	Annual Interest Rate	Annuity to Finance (FC) in (n) Years given (i)
From	To		(n)	Quantity (SY)	Unit Cost (\$/SY)	(PC)	(FC)	(i)	$FCi/((1+i)^n-1)$
2006	2026	2024	2	3,120	\$10.00	\$31,200	\$33,072	0.25%	\$16,515
From	To		(n)	Quantity (SY)	Unit Cost (\$/SY)	(PC)	(FC)	(i)	$FCi/((1+i)^n-1)$
2006	2026	2024	2	3,120	\$2.00	\$6,240	\$6,614	0.25%	\$3,303

## Promenade Shores



### Promenade Recommendations

1. Year Asphalt Built: 2006
2. End of Service Life: 2026
3. Service Life Remaining: 2 Years
4. Pavement Condition: Fair
5. Pavement Marking Condition: Poor
6. Recommendation:  
Mill, Resurface and Repaint in FY 2026-27  
Estimated project cost shown below.

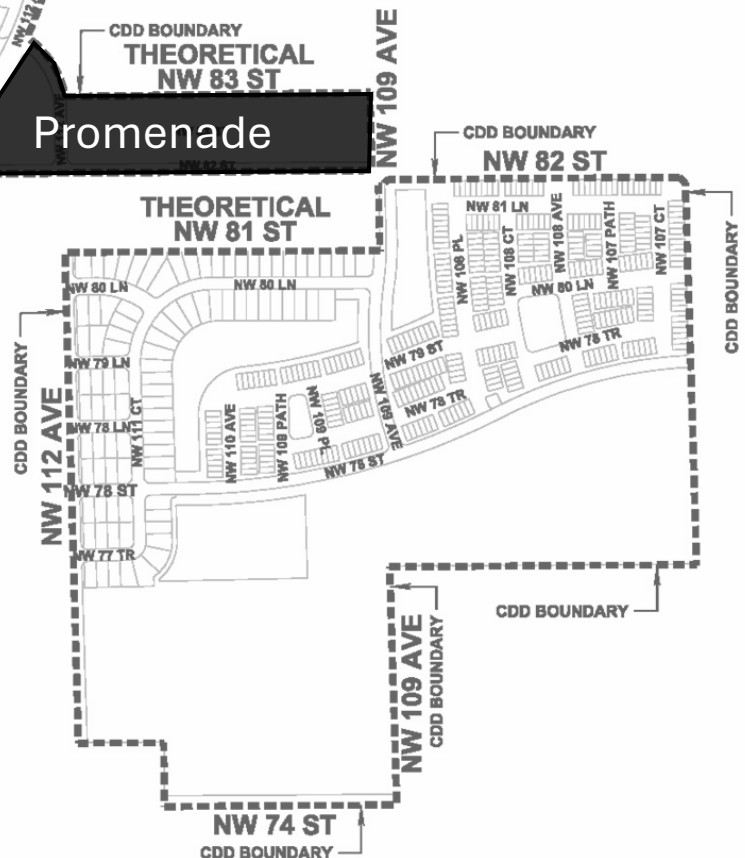

Estimated Costs Asphalt (Table Above) and Markings (Table Below)									
Pavement Service Life (20 Years Estimated)		Present Year	Remaining Service Life (Yrs)	Present Year Cost (PC) of Pavement Replacement (Mill and Resurface 3/4" Thick)			Future Replacement Cost @ End of Service Life*	Annual Interest Rate	Annuity to Finance (FC) in (n) Years given (i)
From	To		(n)	Quantity (SY)	Unit Cost (\$/SY)	(PC)	(FC)	(i)	$FCi/((1+i)^n-1)$
2006	2026	2024	2	9,678	\$10.00	\$96,778	\$102,585	0.25%	\$51,228

From	To		(n)	Quantity (SY)	Unit Cost (\$/SY)	(PC)	(FC)	(i)	$FCi/((1+i)^n-1)$
2006	2026	2024	2	9,678	\$2.00	\$19,356	\$20,517	0.25%	\$10,246



Antilles



Completed in 2025 at a cost of \$259,776

## City of Doral Roads

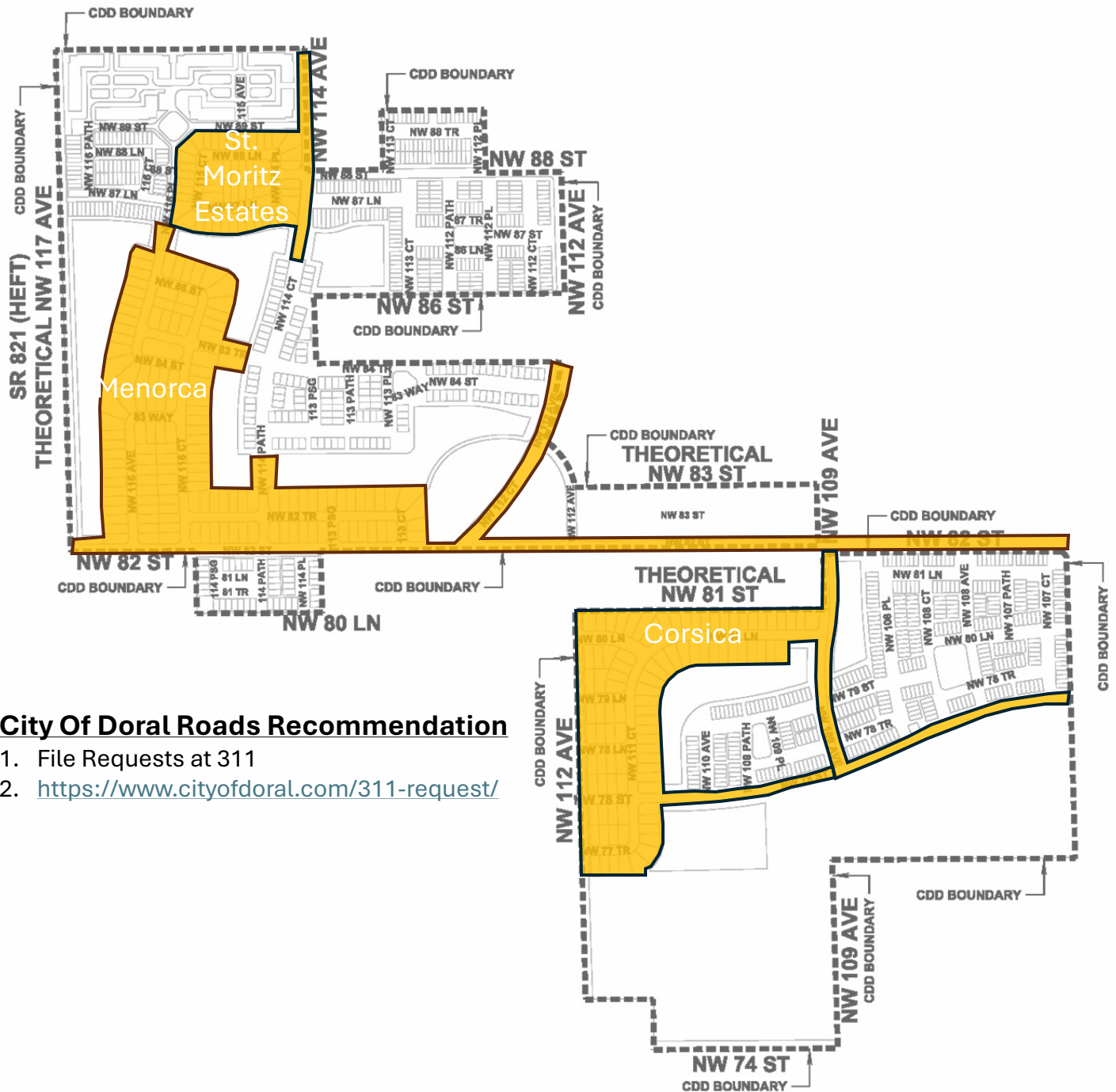

### City Of Doral Roads Recommendation

1. File Requests at 311
2. <https://www.cityofdoral.com/311-request/>

**City is Responsible for Pavement Renewal in These Communities**